

# High resolution Touch panel

# (TENTATIVE) TY-TP65P8-S

## ■Product summary

A touch panel compatible with a 65-inch plasma display, this device achieves the high resolution of 2873 x 1617 while maintaining an extremely thin and compact design.

With a built-in USB interface, the touch panel can be easily connected to peripheral devices of equipment such as personal computers.

## ■Product specifications

(Design and specifications are subject to change without notice)

Spec	
Detection system	Infrared ray interruption
Panel aperture (W x H)	57.2" (W) x 32.5" (H)
Detection range (W x H)	56.7" (W) x 32.0" (H)
Effective detection range	Above detection range +1.0 mm top, bottom, right, left
Operation modes	Input point, Continuous, End point detection *1
Resolution (W x H)	2881 (Horizontal) x 1625 (Vertical) *2
Detection pitch	0.08" x 0.08"
Output system	Coordinate output
Optical elements	361 (Horizontal) x 204 (Vertical)
Optical elements pitch	0.16" x 0.16"
Minimum stylus	0.24" x 0.24"
Scan speed	First touch: 45 msec/frame max.                      Moving: 10 msec/frame max.
Interface Spec	
Interface	USB 1.1
Compliant signal	+DATA, -DATA, VCC, GND
I/F Connector	TYPE B
Structure	
Panel shape	Flat panel
Dimensions (W x H x D)	62.9" (W) x 37.4" (H) x 2.8" (D) (1598 mm x 951 mm x 72 mm) (Except bracket, Inclusive of protruding portion)
Mass	11.0 lbs. (Except bracket)
Escutcheon (frame)	Aluminum
Environment	
Temperature	Operation      0 to 50 °C (Temperature gradient) *3
	Unoperation    -20 to 60 °C (Temperature gradient)
Humidity	Operation      20 to 85 % (Must be no condensation) *3
	Unoperation    10 to 95 % (Must be no condensation)
Main unit	
Power supply (voltage)	DC + 5 V ±10 % (Supplied from USB bus power)
Electric current	DC + 5 V max. 400 mA

\*1 : When using the specific driver software.

\*2 : Resolution: When using the specific driver software.

\*3 : For touch panel only (When attached to a plasma display, be sure to follow the environmental cautions of the equipment in use.)

Accessories            • USB Cable   • Bracket (2 Types)   • Screw (2 Types)   • CD-ROM (USB Driver, Touch panel setting program)  
                                 • USB Fixing bracket   • USB Column screws

# ■Dimensions

Cautions : This drawing is not a scale.

Unit : inches

(Top)

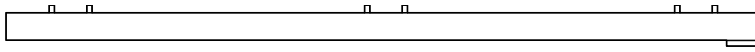

(Front)

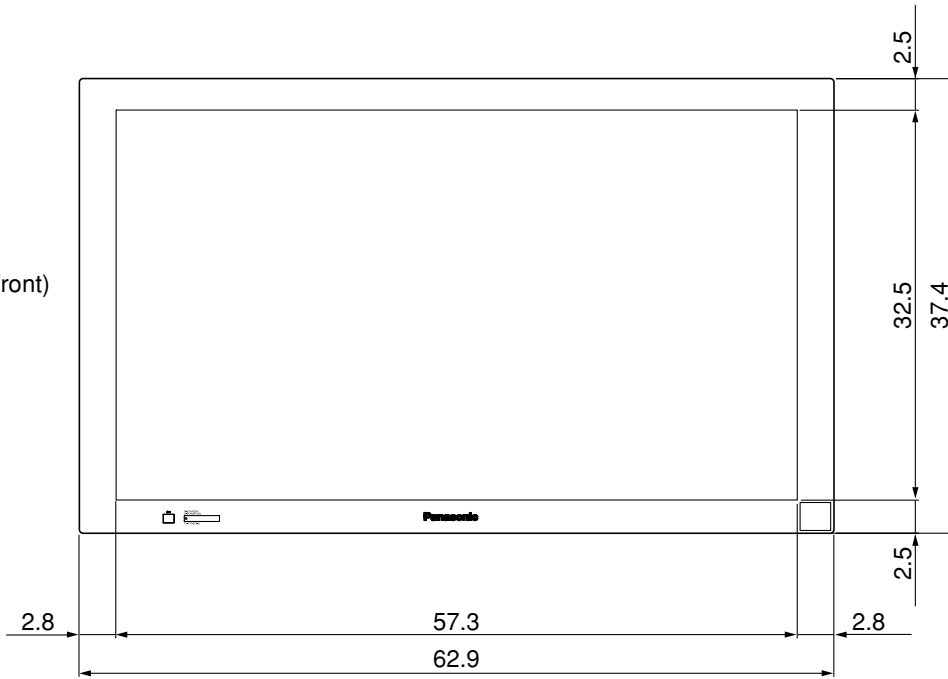

(Side)

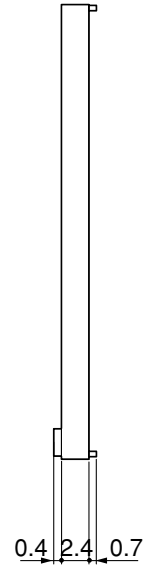

(Rear)

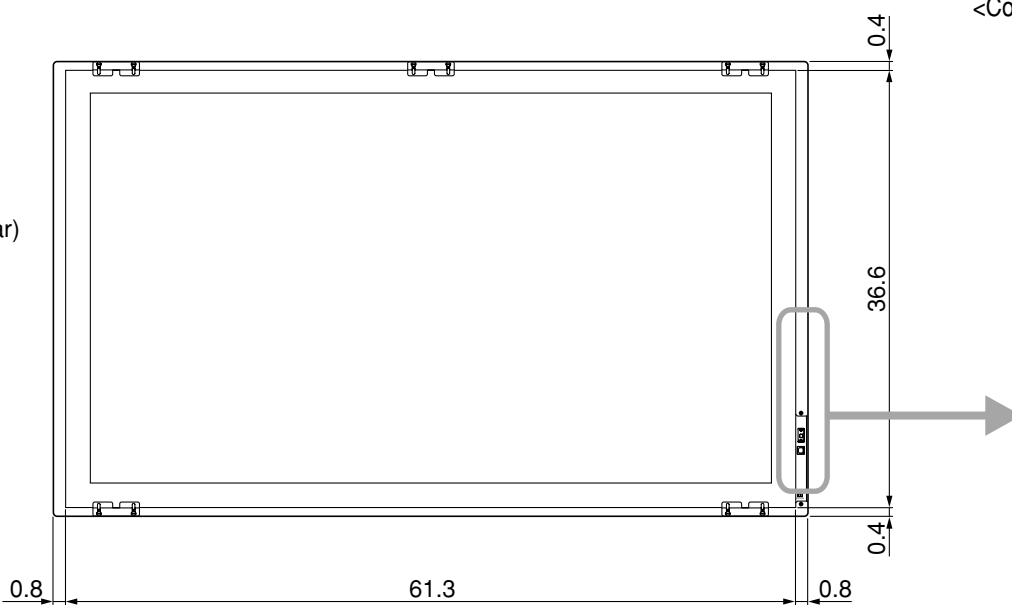

<Connection terminals>

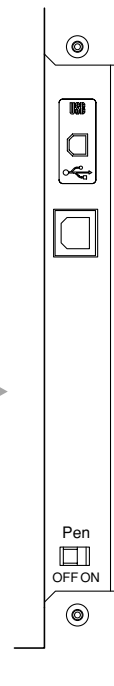

(Bottom)

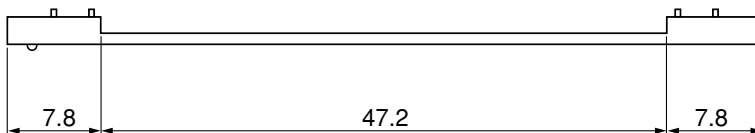

<When installed pedestal> (TY-ST65-K)

